

### materials

**Size:** 24" x 33"

1 package Keepsake Quilting™  
*Heirloom Charm Pack*

½ yard tan print for blocks and  
appliqué background

¾ yard green solid for vines,  
sashing, inner border, and  
binding

½ yard red print for outer  
border

Lightweight interfacing OR  
paper-backed fusible web

6 (⅜"-diameter) green buttons

¾ yard backing fabric

Crib-size quilt batting

**NOTE:** If you are not using  
Keepsake Quilting™ *Heirloom  
Charm Pack* you will need 24 (5")  
squares of assorted red and green  
prints.



### cutting

Patterns for Leaf and Yo-Yo are on page 3. Measurements include ¼" seam allowances. Border strips are exact length needed. You may want to make them longer to allow for piecing variations.

**From each of 12 charm squares,**

**cut:**

- 4 (2½") A squares.

**From remaining charm squares,**

**cut:**

- 6 Yo-Yos.
- 6 Leaves.

**From tan print, cut:**

- 1 (5"-wide) strip. From strip, cut 2 (5" x 16½") rectangles for appliqué background.
- 3 (2½"-wide) strips. From strips, cut 48 (2½") A squares.

**From green solid, cut:**

- 38" of (1⅜"-wide) bias strips for vines. Fold bias strips in thirds, press, and hand baste fold in place to prepare vines for applique.
- 5 (1½"-wide) strips. From strips, cut 2 (1½" x 27½") side inner borders and 6 (1½" x 16½") horizontal sashing strips.
- 4 (2¼"-wide) strips for binding.



Triangle-Square Diagrams



Block Assembly Diagram



Block Diagram

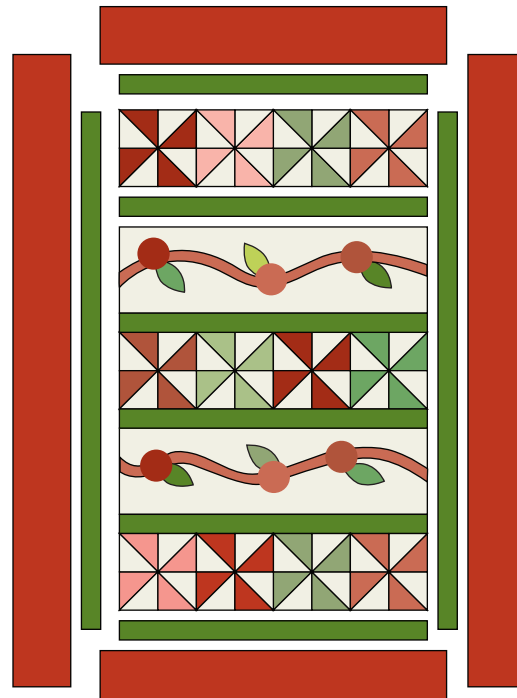

Quilt Top Assembly Diagram

### From red print, cut:

- 3 (3½"-wide) strips. From strips, cut 2 (3½" x 33½") side outer borders and 2 (3½" x 18½") top and bottom outer borders.

### pinwheel row assembly

1. Choose 4 matching print A squares. Place 1 tan A square atop 1 print A square, right sides facing. Stitch diagonally from corner to corner as shown in *Triangle-Square Diagrams*. Trim ¼" beyond stitching. Press open to reveal triangle to make 1 triangle-square. Make 4 triangle-squares.
2. Lay out 4 triangle-squares as shown in *Block Assembly Diagram*. Join pieces to make 1 Pinwheel block (*Block Diagram*). Make 12 Pinwheel blocks in assorted colors.

3. Referring to *Quilt Top Assembly Diagram*, join 4 Pinwheel blocks to make 1 Pinwheel row. Make 3 Pinwheel rows.

### appliqué row assembly

1. Referring to *Sew Easy: Making Yo-Yos* on page 3, make 6 assorted yo-yos.
2. Referring to *Sew Easy: Interfacing Appliqué* on our Web site at [FonsandPorter.com/interapp](http://FonsandPorter.com/interapp), make 6 assorted leaves.
3. Appliqué vine and leaves on 1 tan (5" x 16½") rectangle as shown in *Quilt Top Assembly Diagram*. Position 3 yo-yos. Sew a button on each yo-yo, stitching through all layers.
4. Repeat to make 2 appliqué rows.

### quilt assembly

1. Join Pinwheel rows, appliqué rows, and green sashing strips as shown in *Quilt Top Assembly Diagram*.
2. Add green side inner borders to complete quilt center.
3. Add red print top and bottom borders to quilt center. Add red print side borders to quilt.

### finishing

1. Layer backing, batting, and quilt top; baste. Quilt as desired.
2. Join 2¼"-wide green strips into 1 continuous piece for straight-grain French-fold binding. Add binding to quilt.

# Making Yo-Yos

Follow these simple steps to make yo-yos.

1. Cut circle using pattern below.
2. Turn under raw edge of circle  $\frac{1}{4}$ " to wrong side and take small running stitches around edge through both layers (*Photo A*). Use quilting thread or other strong thread that will not break when gathering.
3. Pull thread to gather circle with right side of fabric facing out. Make a knot to hold circle closed. Gathered side is front of yo-yo (*Photo B*).

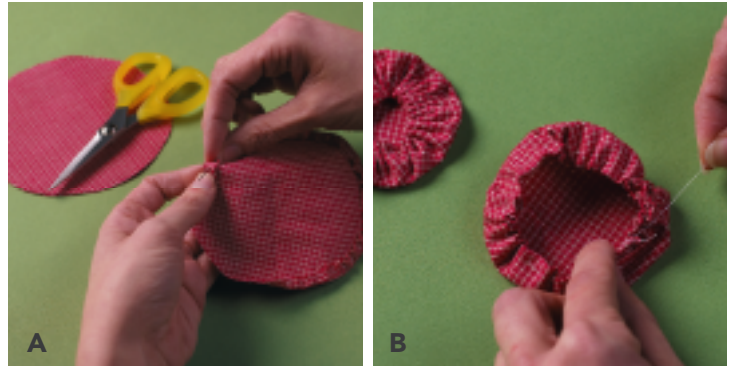

## Sew Smart<sup>TM</sup>

**Do not make running stitches too small. Longer stitches make the circle easier to gather, and the "hole" smaller.**

—Marianne

